

Marghita Townhall Romania



Educational infrastructure – the basis of local community development



Workshop on the IJLET Tisza River Development Program: A Cross-Border SDI Approach
– “From Local to Global” – European Parliament, Brussels



Marghita – short presentation

- Marghita is a young town in full expansion, situated in the North-West of Romania, in the proximity (30 km) of the Romanian-Hungarian border, located on the banks of Barcau river, which is a tributary to Tisa.
- More than 18.000 inhabitants but including the agglomeration of rural areas, there are over 70.000 people leaving here.
- Ethnically diverse population: Romanians, Hungarians, Romanies, other nationalities.



Education in Marghita area.

- In Romania, compulsory education has been extended from eight to ten years, which has led to the increase of the school population and of the pressure on the current infrastructure. The access to education of children coming from economically declining areas, especially from rural areas and vulnerable social environments (especially the Roma population) is difficult because of poor school infrastructure, long distances to the nearest schools, lack of means of transport and school accommodation in the proximity of schools. Therefore, one of the priorities of the local educational strategy is to create and develop pre-university educational campuses.
- These campuses are designed to integrate in the same place all the activities of the educational process (teaching, practice, social activities, leisure activities, etc.) by concentrating the educational buildings and services. A campus consists of: the school, accommodation facilities, canteen, library, special workshops meant to develop practical capabilities, gyms.
- Some components of the campus (e.g. schools and apprentice facilities) can be used not only for initial training but also for permanent education or adult education activities and can be adjusted to the local needs.



Education in Marghita area

2 high schools of different profiles:

- 1 theoretical high school “Octavian Goga National College” where sciences and social studies are taught. Number of the students: 1288 of who 45 % come from rural environment. The teaching is done in Romanian for 800 students and in Hungarian for 500 students.
- 1 vocational high school “Horea Agriculture School Group” where technological subjects are taught aiming at preparing apprentices and tradesman in different domains: farmers, veterinary technician, mechanics, masons, etc. Over 450 students study here, of who 70% come from rural environment.

A number of 1700 students attend these 2 high schools which cover the options of all the young people in the region.

A graphic illustration for educational infrastructure. It features a yellow spiral notebook on the left, a black binder with a pen and a document in the center, a white architectural drawing of a building on the right, and a young woman with a red backpack on the far right. The background is green with yellow circles and a white grid pattern.

Educational infrastructure

The lack of investments and reforms in these school has given birth to the following problems:

- at the national college 45 classes study in only 24 classrooms, which is the reason why the courses are organized in two shifts AM and PM (sometimes even till 9 PM)**
- the absence of a boarding school with a canteen for the students who came from the other localities creates a big member of commuters – over 700 students in both high schools.**
- lack of accommodation from teachers coming from other places.**
- lack of other facilities indispensable for an effective educational process: gym, well-equipped laboratories, school buses, etc.**

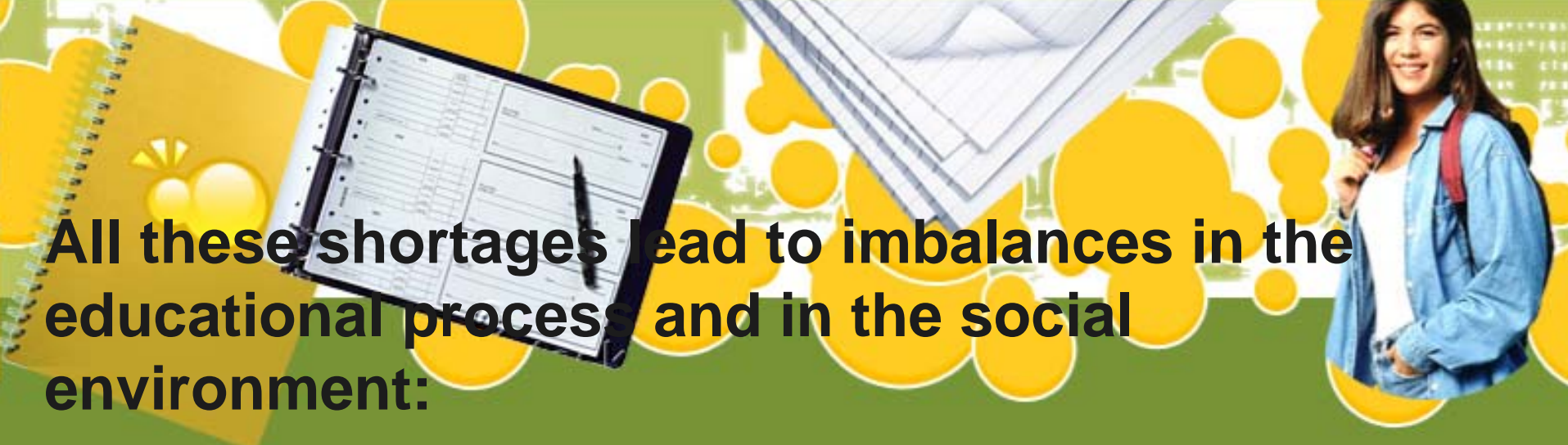

All these shortages lead to imbalances in the educational process and in the social environment:

- ❑ Lower efficiency of students in the afternoon shift, proven even by psychological studies consisting in diminished attention, concentration and motivation and exhaustion.
- ❑ Commuting has a negative impact of the students coming from rural areas because of hard commuting conditions, late arrival at home, little time left for studying, tiredness, stress.
- ❑ The increase of school abandonment at young ages, especially in the case of underprivileged students (for instance, there is no student of Romany nationality at O.Goga National College)
- ❑ Reduced possibilities of organizing different courses meant to liquidate illiteracy and professional reemployment courses for adults.



Measures to be taken for the improvement of the educational system:

We suggest 2 categories of measures:

- ✓ Direct investments in school infrastructure
- ✓ Implementation of some educational programmes in accordance with the needs of the local community.

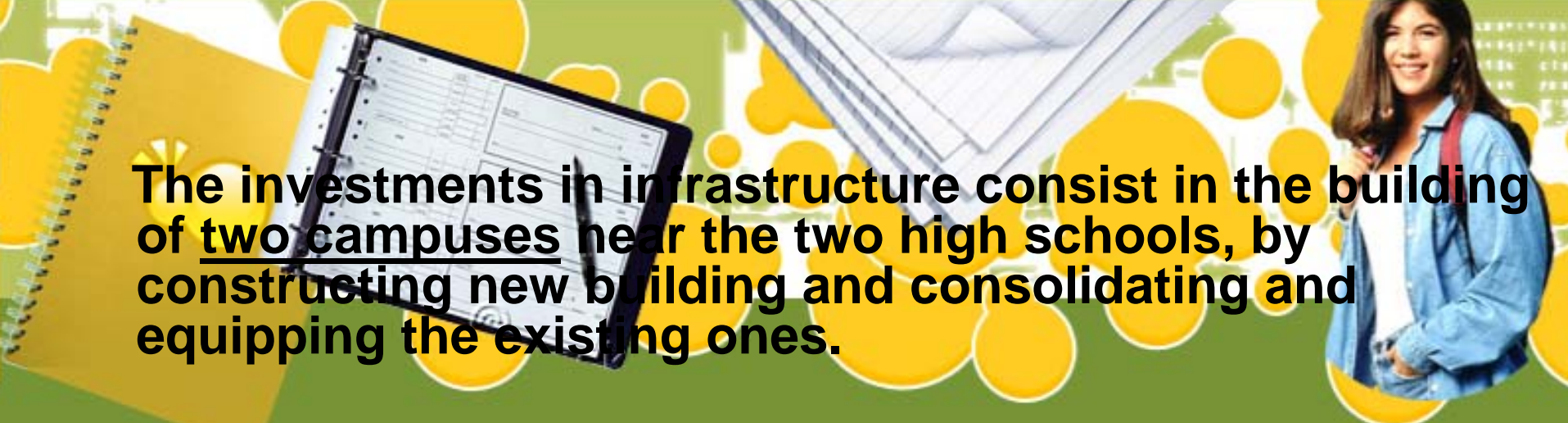

The investments in infrastructure consist in the building of two campuses near the two high schools, by constructing new building and consolidating and equipping the existing ones.

A) O. Goga National College needs:

- ❖ **a new building for 24 new classrooms**
- ❖ **new buildings for the canteen and boarding school consisting of 40 rooms for students and teachers.**

The estimated value of the investment: 2.500.000 Euro

B) “Horea Agriculture School Group” needs investments for the rehabilitation of old buildings used as classrooms, canteen and accommodation for students.

The estimated value of the investment: 600.000 Euro

Note: The data used for the calculation of both estimated values have been taken from the phesability analyses of the investments.

COLEGIUL NATIONAL
OCTAVIAN GOGA

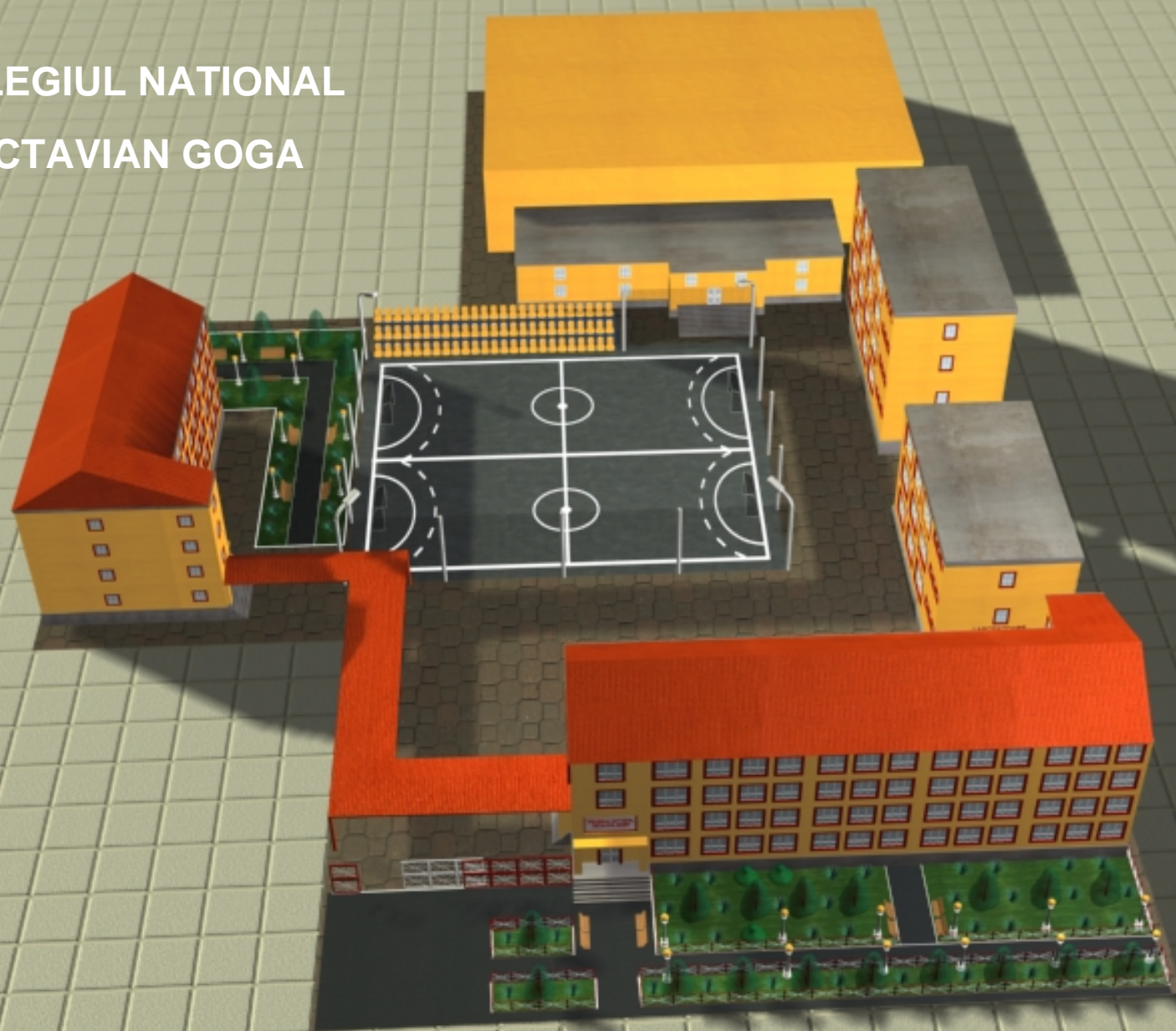

The background features a collage of educational and professional items. On the left, there is a yellow spiral-bound notebook with a pen resting on it. In the center, a stack of white papers or documents is visible. On the right, a young woman with long dark hair, wearing a blue denim jacket over a white top and carrying a red backpack, is smiling. The background is decorated with various yellow circular and abstract shapes.

The results of these investments would be:

- improvement of teaching-learning conditions, in just one shift – AM
- reduction of commuting and a bigger number of students coming from rural areas.
- increasing number of young teachers, interested in settling down in Marghita and making their career here
- more facilities for education and training of adults, who will have the chance to attend afternoon courses.

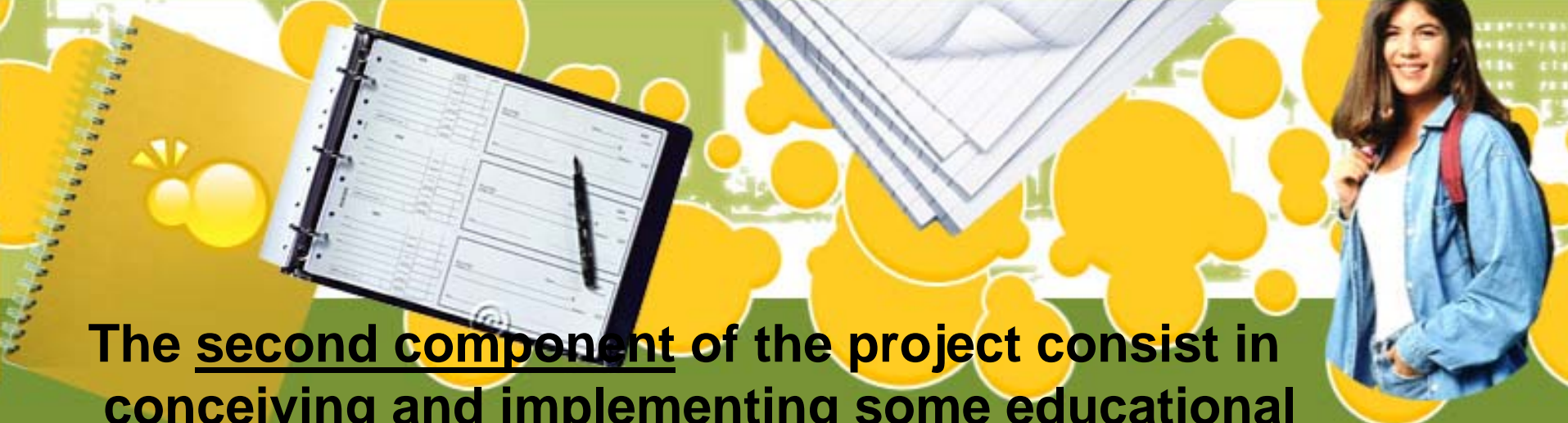

The second component of the project consist in conceiving and implementing some educational programmes, especially for adults, in accordance with the economic and social needs of the local community.

The durable integration of the low qualified work hand on the labour market can only be realized by providing adequate professional training. At present there are limited possibilities of permanent education as long as the school is not yet a provider of permanent education and professional training but only a provider of initial education.

The background features a collage of educational and professional items. On the left, there is a yellow spiral-bound notebook. In the center, a black binder holds a white document with a grid and a pen resting on it. On the right, a young woman with long dark hair, wearing a blue denim jacket over a white top and a red backpack, is smiling. The background is decorated with various yellow circles and a faint architectural drawing of a building.

Suggested measures:

- ✓ **Develop specific educational packages for the adults who don't have a minimum school preparation of 10 years:**
 - **basic theoretical courses organized at “O. Goga National College”**
 - **training courses for different jobs in demand on the labour market organized at the “Horea Vocational School”**
- ✓ **creation of a centre for professional consultancy and guidance for adults at O. Goga National College.**
- ✓ **creation of a system of qualification and requalification according to the permanent education principle**
- ✓ **increase of partnerships and dialogue between the two campuses and the business community with the purpose of adjusting the educational offer to the labour market requirements.**



By these investments, Marghita municipality would consolidate its position as a provider of quality education and professional training, aiming at supporting economic growth and integrating the work force of over 70.000 inhabitants.

Thank you for your attention.

Marghita Townhall

primaria@marghitaonline.ro